

# DAC

## Diffusore ad alette curve



### Distribuzione

Comfort ad alta  
efficienza energetica

DIFFUSORI



**Prodotto**

DAC

**Impiego**

A soffitto/parete, in mandata.

Altezza di installazione: 2,4 - 3,2 m

**Costruzione**

Alluminio anodizzato o RAL 9016

#### CAPITOLATO

Diffusori ad alette curve

#### FISSAGGIO

Fissaggio a mezzo clips o con viti frontali (a richiesta)

#### ACCESSORI

KSEL Serranda di taratura in acciaio zincato con alette a movimento contrapposto  
PBO Plenum in acciaio zincato standard o isolato, con o senza rete equalizzatrice

### DISEGNI

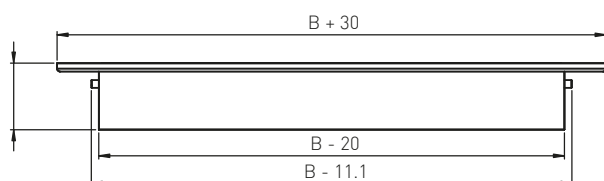

VISTA DAL BASSO - SCALA 1:2

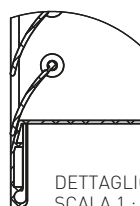

DETTAGLIO C  
SCALA 1 : 1

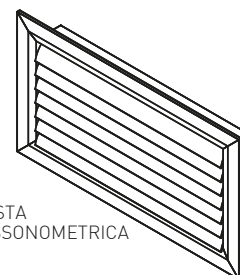

VISTA  
ASSONOMETRICA

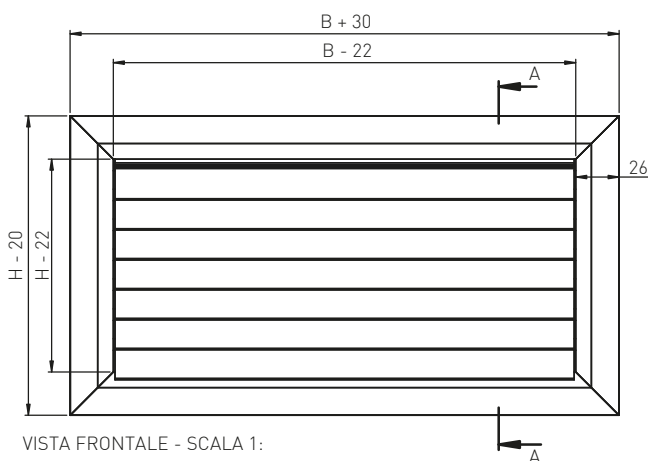

VISTA FRONTALE - SCALA 1:

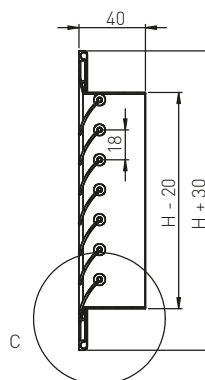

SEZIONE A-A  
SCALA 1 : 2

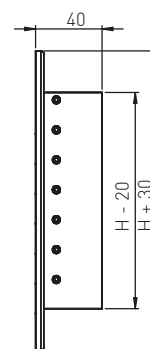

VISTA LATERALE  
SCALA 1:2

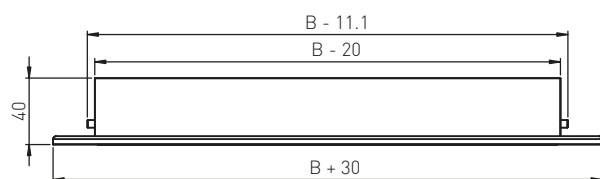

VISTA DALL'ALTO - SCALA 1:2

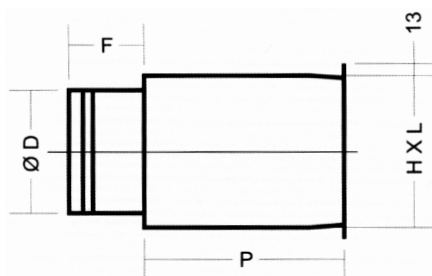

PBOS-PBOI PLENUMCON COLLARINO ORIZZONTALE

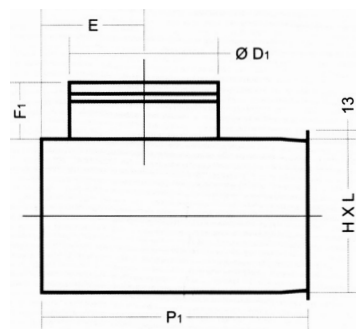

PBVS-PBVI PLENUMCON COLLARINO VERTICALE

## TABELLA DI SELEZIONE

DAC Modello	A <sub>k</sub> m <sup>2</sup>	Q [m <sup>3</sup> /h]		L <sub>WA</sub> [dB(A)]		X <sub>(0,25)</sub> - Y <sub>(0,25)</sub> [m]		Dpt [Pa]	
		min	max	min	max	min	max	min	max
DAC 200x100	0,0068	100	210	29	45	1,7-2,5	4,3-5,3	10	50
DAC 300x100	0,0104	150	320	31	48	2,5-3,0	5,1-7,4	10	50
DAC 400x100	0,0139	200	440	33	50	3,0-3,8	6,0-9,5	10	50
DAC 300x150	0,0157	230	490	34	50	3,2-4,3	6,2-10,3	10	50
DAC 500x100	0,0174	250	550	34	51	3,3-4,6	6,6-11,2	10	50
DAC 600x100 400x150 300x200	0,0210	300	660	34	51	3,5-5,3	7,2-12,8	10	50
DAC 500x150	0,0263	380	820	36	52	3,9-6,5	7,9-15,0	10	50
DAC 800x100 400x200	0,0281	410	880	36	53	4,0-6,9	8,2-15,8	10	50
DAC 600x150 300x300	0,0316	460	990	37	53	4,2-7,5	8,6-17,2	10	50
DAC 500x200	0,0351	510	1100	37	54	4,4-8,1	9,0-18,5	10	50
DAC 800x150 600x200 400x300	0,0422	610	1320	38	55	4,8-9,3	9,8-21,1	10	50
DAC 1000x150 500x300	0,0528	770	1650	39	56	5,3-11,0	10,9-24,7	10	50
DAC 800x200	0,0564	820	1770	40	56	5,5-11,6	11,3-26,0	10	50
DAC 600x300	0,0634	920	1990	40	57	5,7-12,6	11,9-28,2	10	50
DAC 1000x200	0,0705	1020	2210	41	57	6,0-13,5	12,5-30,4	10	50
DAC 800x300	0,0847	1230	2650	42	58	6,5-15,5	13,6-34,5	10	50
DAC 1000x300	0,1059	1540	3320	43	59	7,3-18,3	15,1-40,4	10	50
DAC 800x400	0,1130	1640	3540	43	60	7,5-19,1	15,6-42,3	10	50
DAC 595x595	0,1250	1810	3920	44	60	7,8-20,5	16,3-45,4	10	50
DAC 1000x400 800x500	0,1413	2050	4430	44	61	8,3-22,4	17,3-49,4	10	50
DAC 1000x500	0,1767	2560	5530	45	62	9,1-26,2	19,2-57,6	10	50
DAC 300x300	0,0317	460	990	37	53	1,3-2,7	2,7-5,5	10	50
DAC 400x400	0,0565	820	1770	40	56	1,7-3,4	3,5-7,0	10	50
DAC 500x500	0,0884	1280	2770	42	58	2,0-4,1	4,3-8,5	10	50
DAC 595x595	0,1252	1820	3920	44	60	2,4-4,7	4,9-9,9	10	50



## DIAGRAMMA DI SCELTA RAPIDA

